

HEARTHSTONE MANORSM

at New Milford

The Fairmont

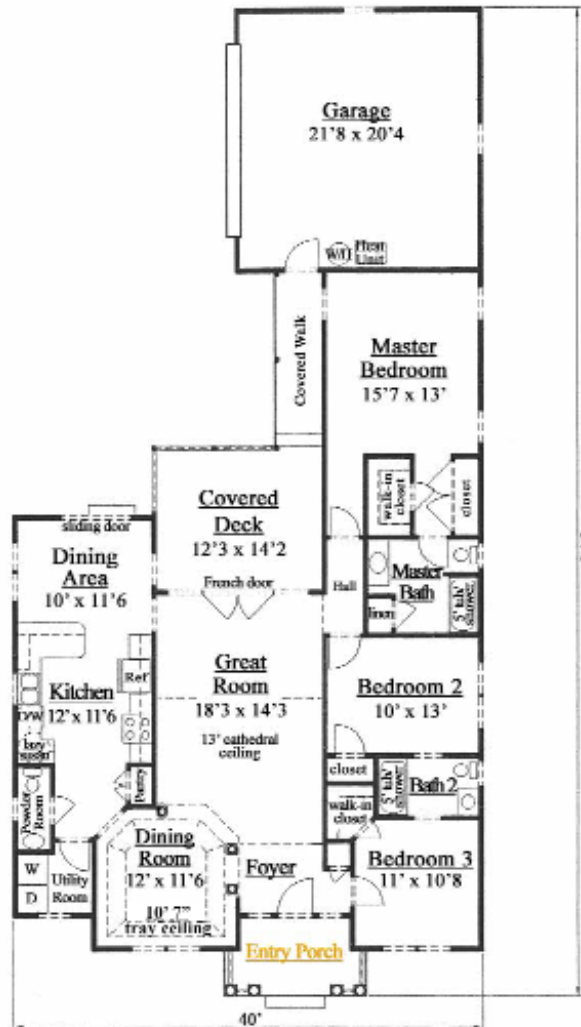

3 bedrooms, 2.5 baths
Living Area: 1,646 sq. ft.
Garage: 465 sq. ft.



All dimensions are approximate and subject to modification.

Updated 9/15/04

The Fairmont

Crowned by a stately hip roof and complemented by well-proportioned gables and graceful columns, this traditional 3-bedroom, 2-bath home exemplifies refined elegance. The bright, lofty foyer leads to an expansive great room, accented by a wall of charming French doors that bring in light and provide access to the covered deck. Adjoining the foyer is an elegant formal dining room, defined by three columns and brightened by twin windows. A tray ceiling in the dining room, a 12' vaulted ceiling in the great room and 9' ceilings throughout add richness to this classy design. The substantial kitchen includes a large pantry, convenient powder room and a roomy breakfast area brightened by sliding glass doors. A private hallway leads to the secluded master suite that features abundant closet space and a full bath. The additional two sizable bedrooms share a hall bath.

Options

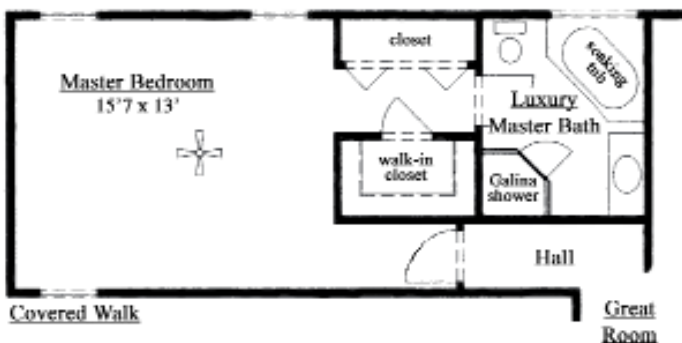
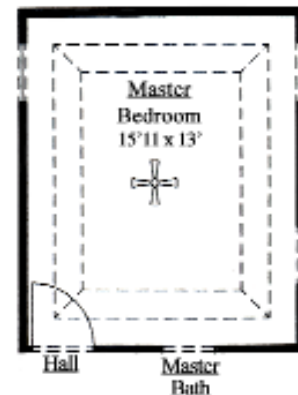
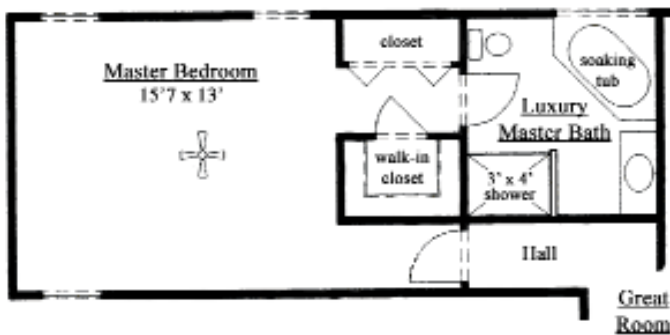
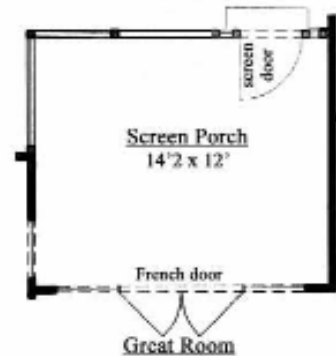
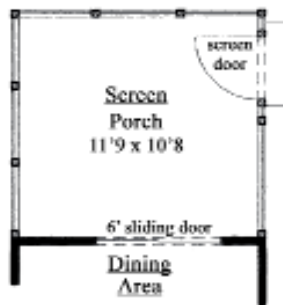

The Fairmont
Elevation A



All dimensions are approximate and subject to modification.



Updated 4/30/04